

trial

ALUMINIO NEL MOBILE

ANTA MINI IKS

Anta Battente



Profili e accessori per montaggio Ante Mini Iks
Profiles and Accessories for Mini Iks Door

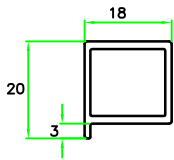

ISM-956
Profilo Anta
vetro incollato
door profile
with glue glass

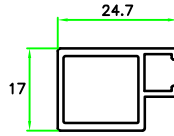

ISM-955
Profilo Anta
con guarnizione vetro
door profile
with gasket for glass

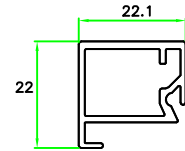

ISM-957
Profilo Anta
con guarnizione vetro
door profile
with gasket for glass

ISM-986 Profilo maniglia
(altezza standard 120 mm)
Handle profile
(standard height 120 mm)

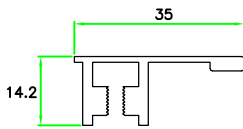

GU-4 Guarnizione
per vetro
Gasket For glass

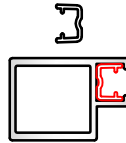

GU-C-1000
Guarnizione per vetro
Gasket For glass

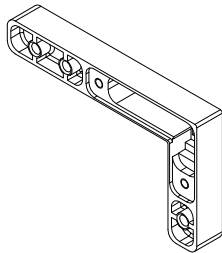

ISM-G Giunto angolare di
collegamento Dx/Sx per anta
Mini IKS con Cerniera ISM-CE

right / left connecting joint
MINI IKS door with
hinge ISM-CE

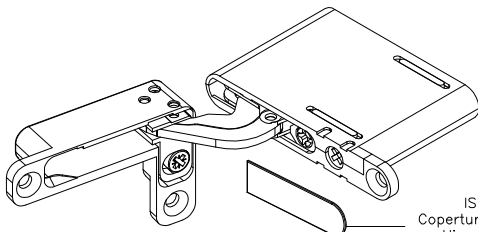
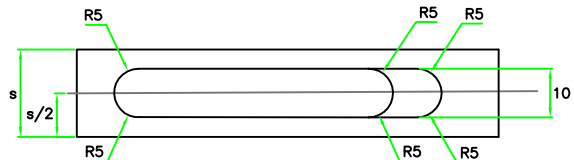

ISM-MO
Copertura cerniera
Hinge cover

Cerniera MINI IKS:
MINI IKS ISM-CE ammortizzata
MINI IKS Hinge ISM-CE With damper

ISM-CE-MC con molla al contrario
MINI IKS Hinge ISM-CE-MC reverse spring

ISM-CE-S/AMM Libera
MINI IKS Hinge ISM-CE-S/AMM no damper

Apertura 103°, Limite di portata 17 KG
Openinig 103°,Max load capacity 17 kg

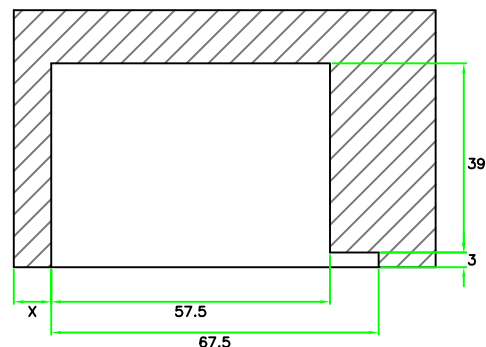

Lavorazione del pannello legno base/top
per inserimento corpo cerniera

Working detail for top/bottom wooden
panel to put body hinge

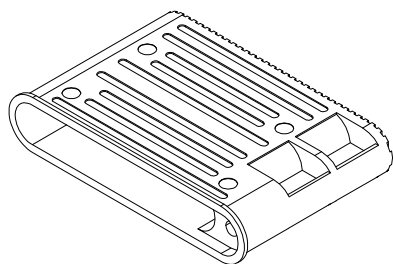

Supporto SUPP-ISM-CE-CF-SS
fissaggio tramite viti
Hinge support SUPP-ISM-CE-CF
Fixing by screw

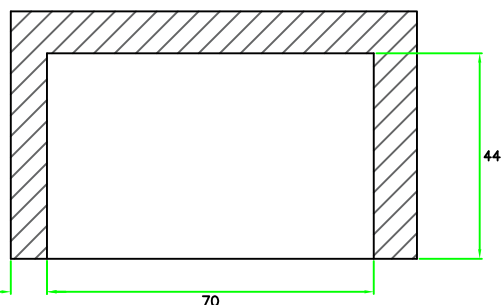
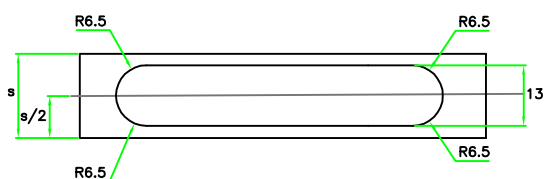

Lavorazione del pannello
legno base/top per inserimento
corpo cerniera con supporto

Working detail for top/bottom
wood panel to put
body hinge with support

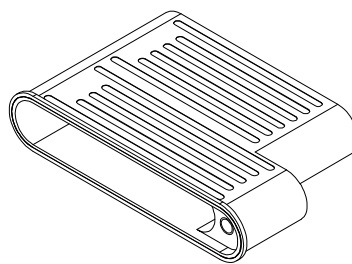

Supporto SUPP-ISM-CE-SF
fissaggio tramite colla
Hinge support
SUPP-ISM-CE-SF
Fixing by glue

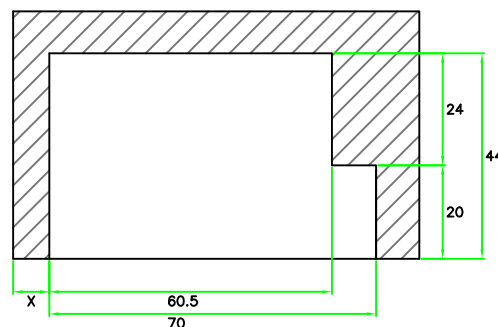
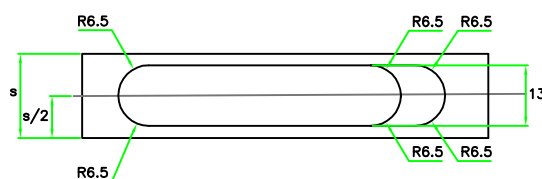

Lavorazione del pannello
legno base/top per inserimento
corpo cerniera con supporto

Working detail for top/bottom
wood panel to put
body hinge with support

Dati tecnici per calcolo sormonto anta MINI IKS
Mini Iks door Technical data to calculate door overlap

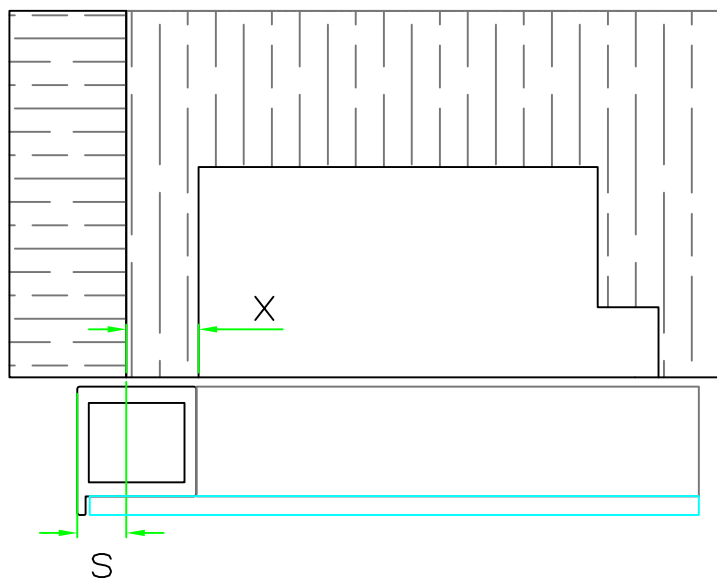

s = Sormonto anta a
discrezione del cliente
door overlap at customer's discretion

$$D = 2,6 \text{ mm}$$

$$x = (17 + D) - s$$

Istruzioni di montaggio Ante Mini Iks
Assembling instruction: Mini Iks Door

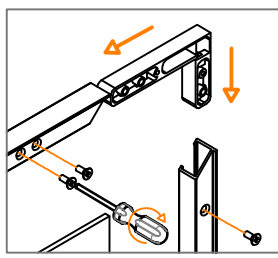

ISM-G
Giunto angolare dx/sx
Connecting joint

Vista Frontale Anta
Front door view

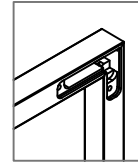

Vista posteriore Anta
Back door view

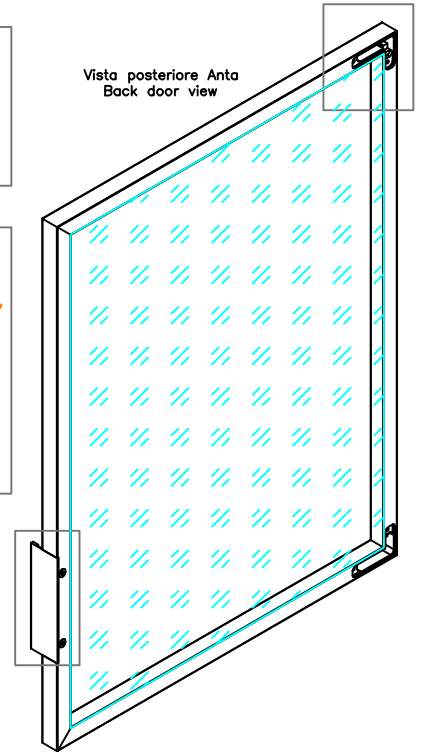
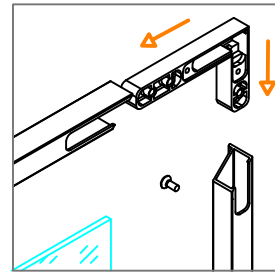

ISM-956
Profilo Anta vetro incollato
door profile with glue glass



120

ISM-986
Profilo maniglia
Handle profile

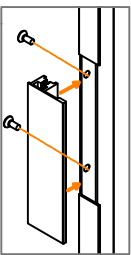

Retro
Back

Vetro Spessore 4 mm
Glass 4 mm thickness

Fronte
Front

Vista posteriore Anta
Back door view

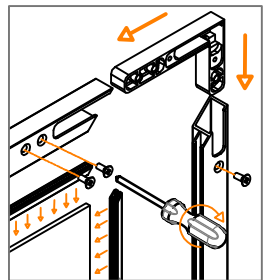

GU-4 Guarnizione
per vetro
Gasket For glass

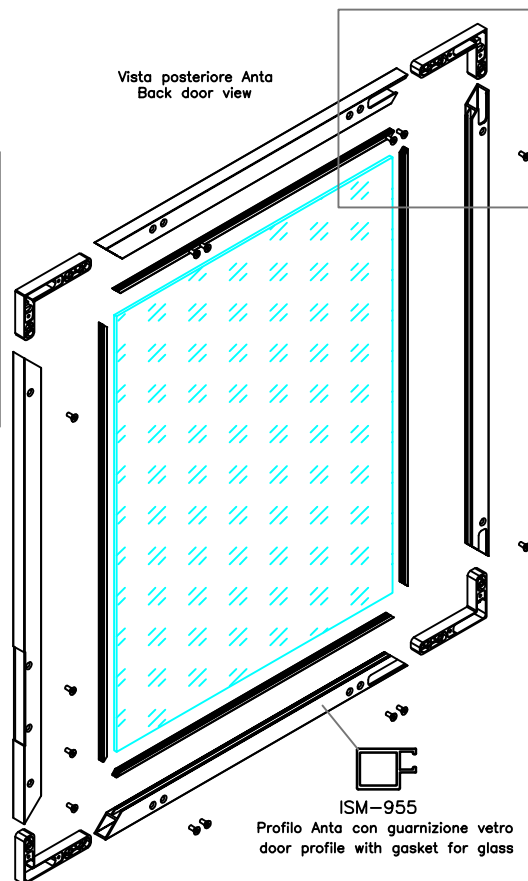

Vista Frontale Anta
Front door view

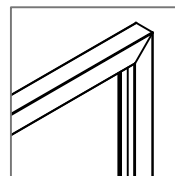

Retro
Back

Vetro Spessore 4 mm
Glass 4 mm thickness

Fronte
Front

ISM-955

Profilo Anta con guarnizione vetro
door profile with gasket for glass

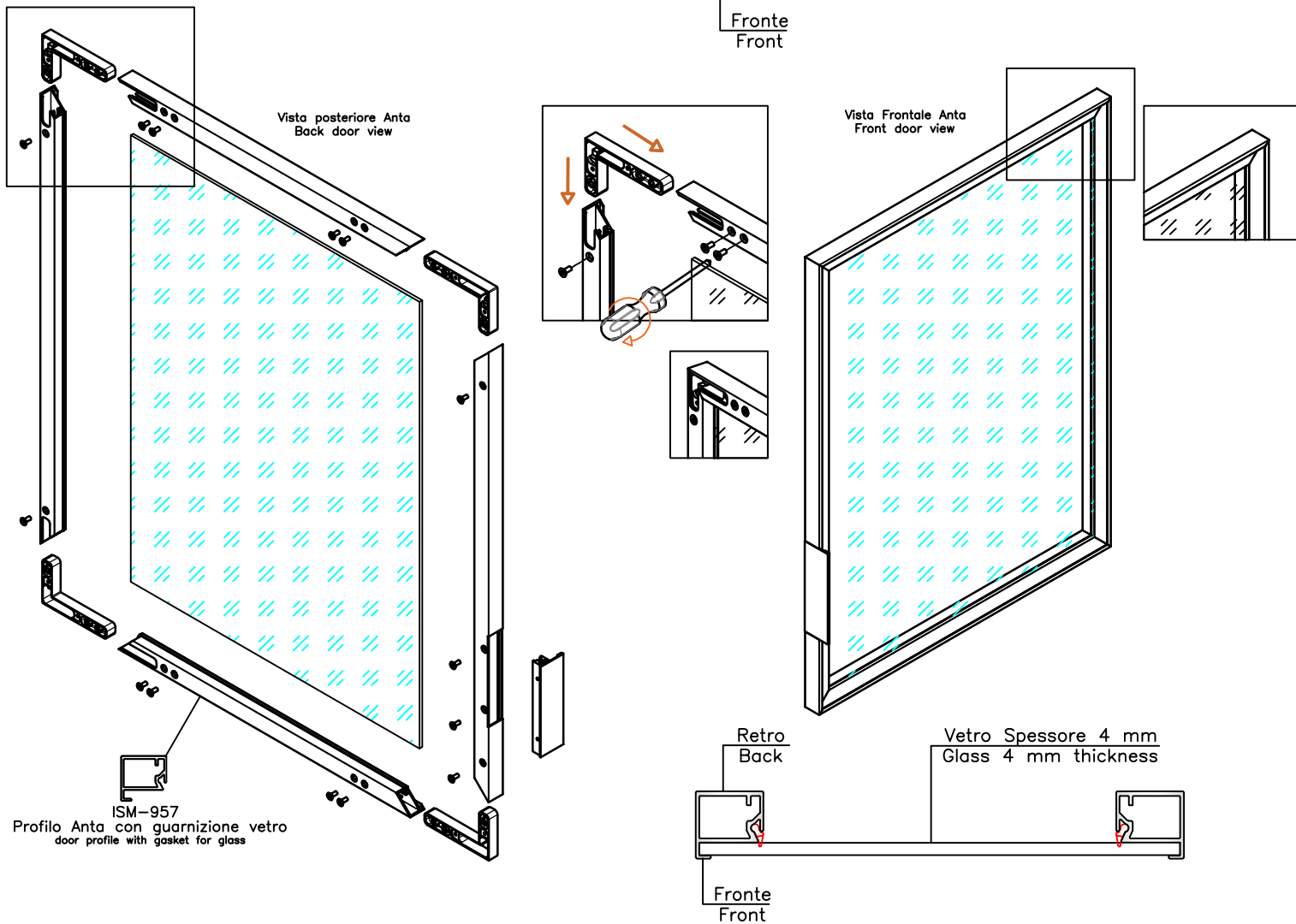
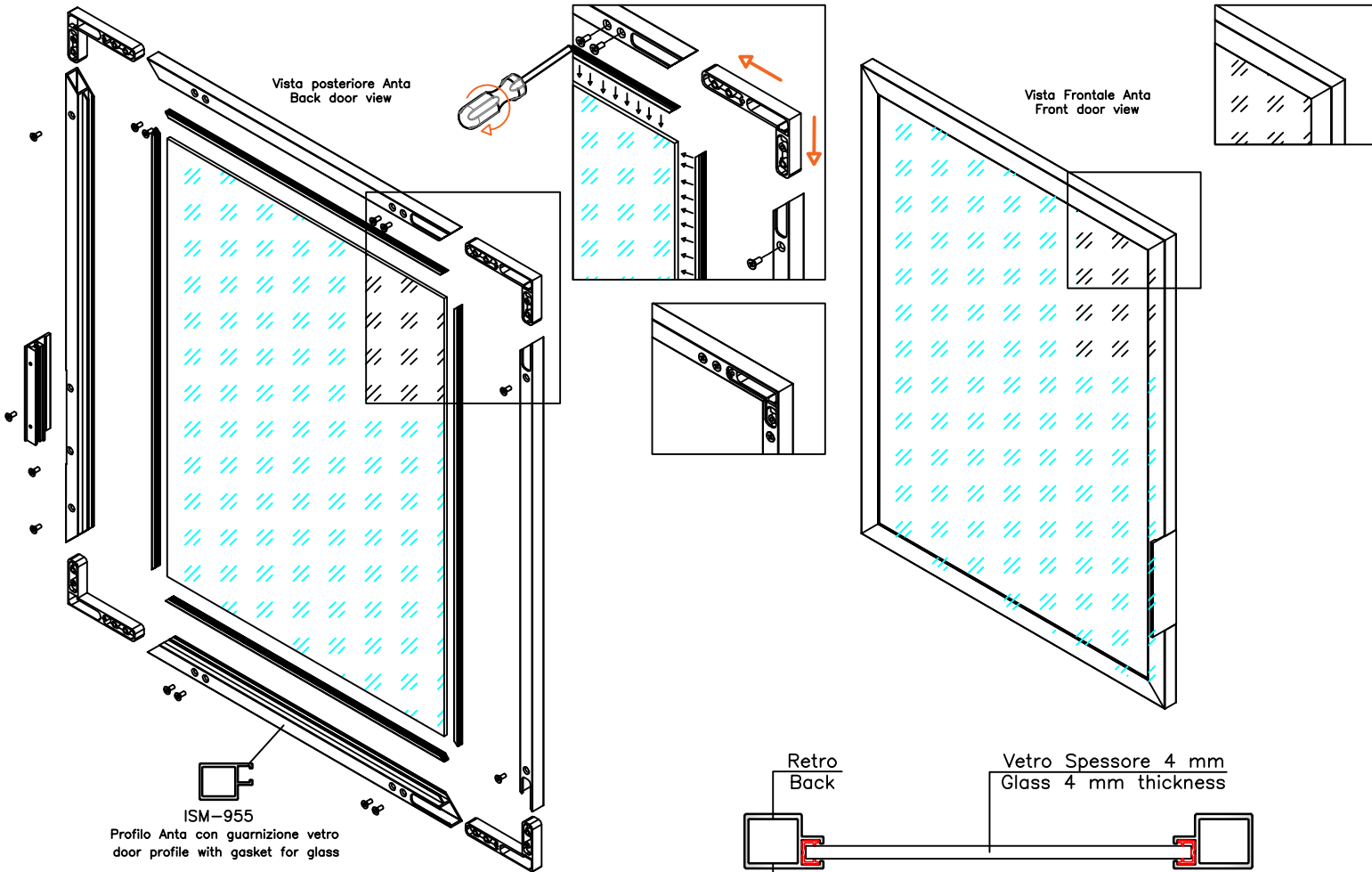

Cerniera MINI IKS
MINI IKS Hinge

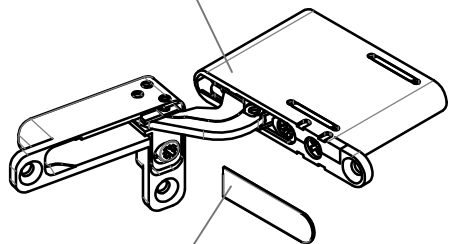

ISM-MO
Copertura cerniera
Hinge cover

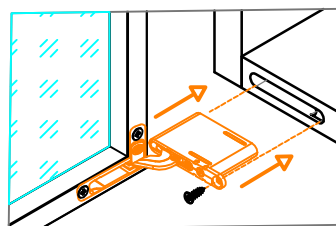
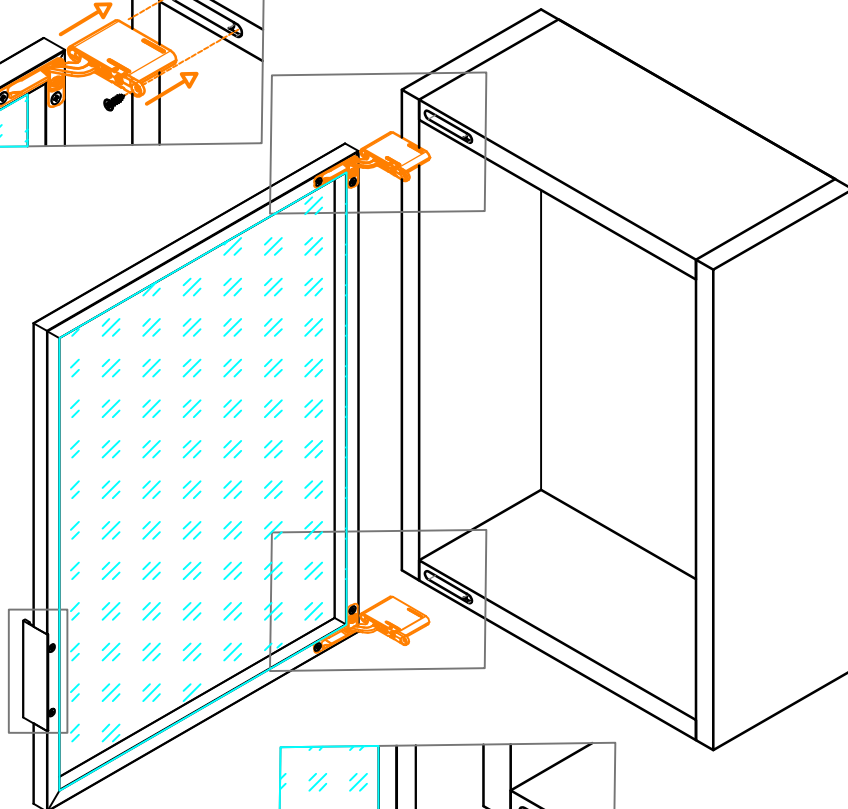
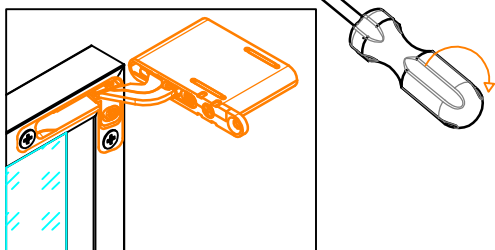
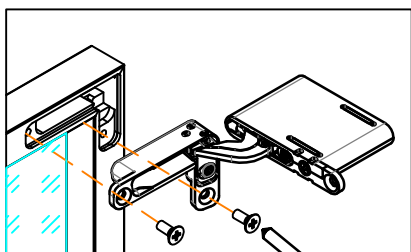
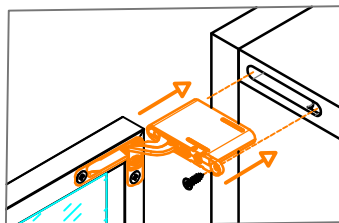

Regolazione dell'anta in altezza
Height adjustment

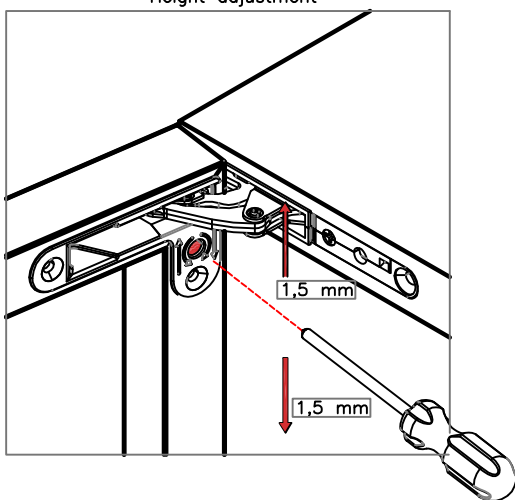

Regolazione dell'anta
in larghezza
Width adjustment

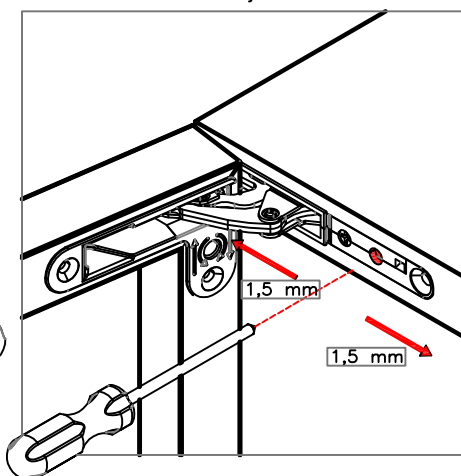

Regolazione dell'anta
in profondità
Depth adjustment

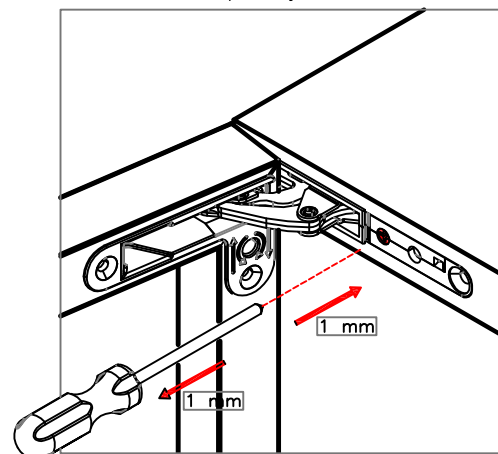

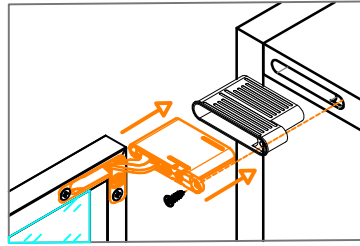
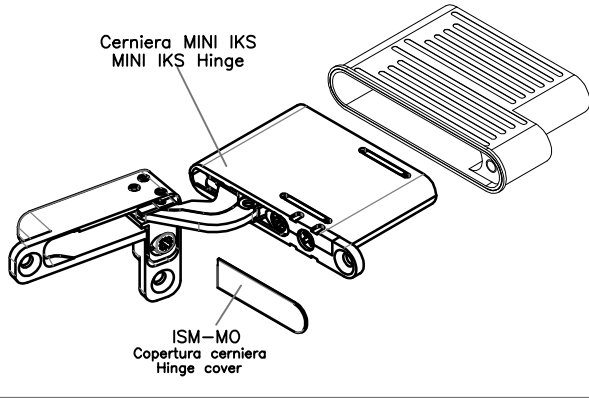

Supporto SUPP-ISM-CE-SF
fissaggio tramite colla
Hinge support SUPP-ISM-CE
Fixing by glue

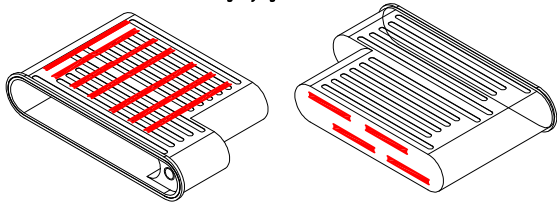

Supporto SUPP-ISM-CE-CF
fissaggio tramite viti
Hinge support SUPP-ISM-CE-CF
Fixing by screw

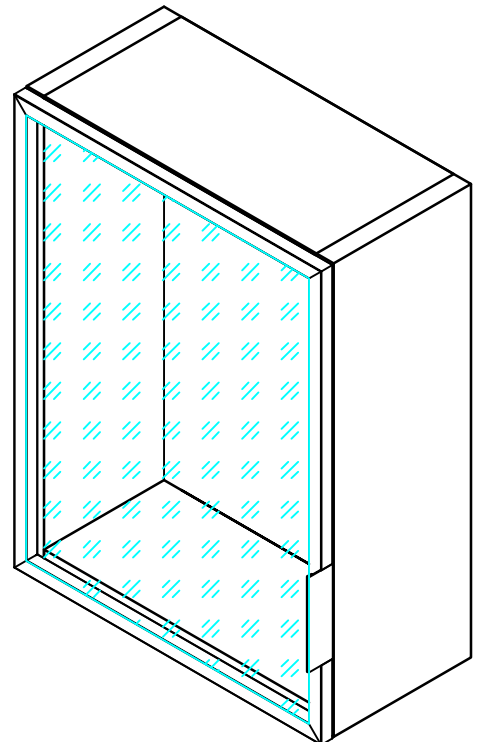
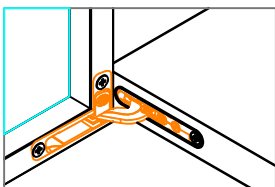
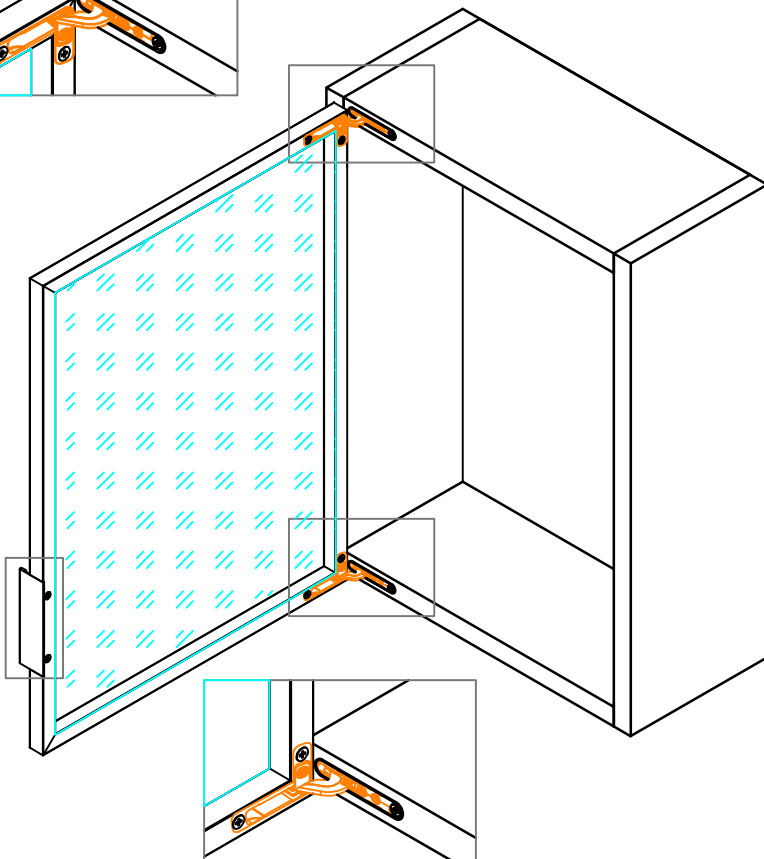
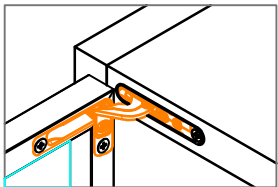
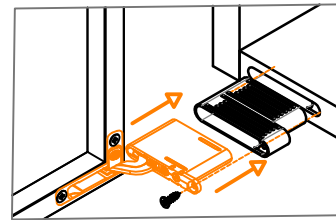
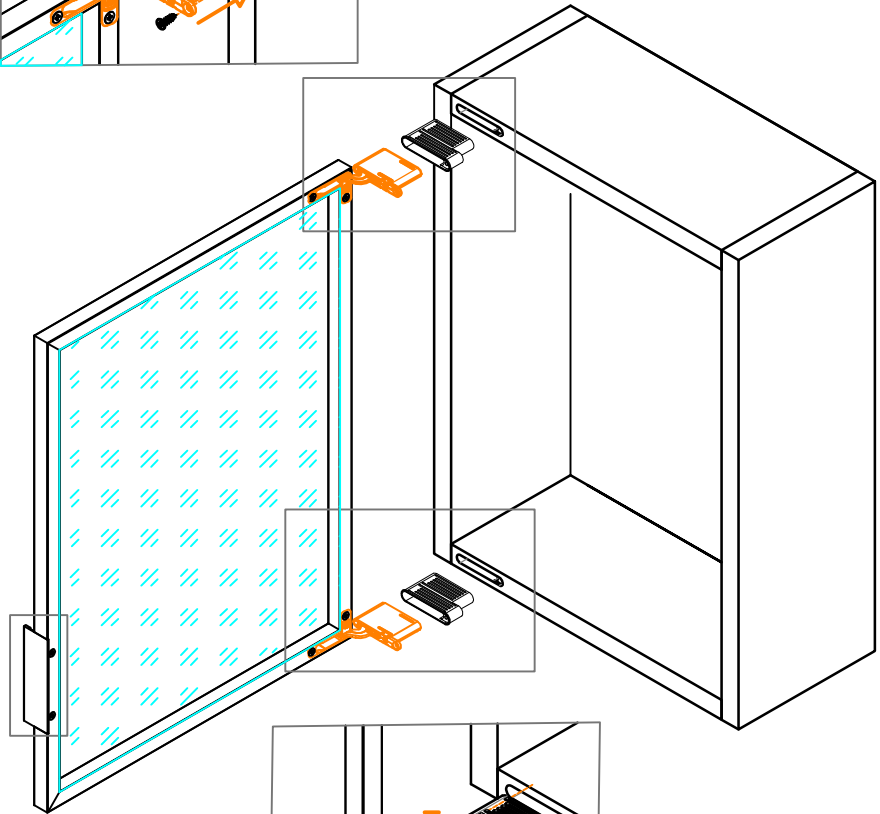
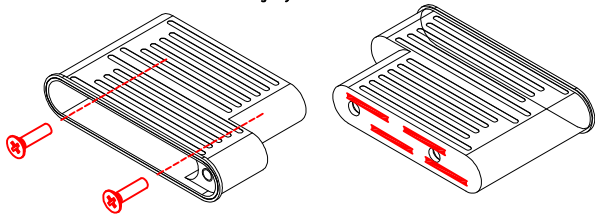

Dati tecnici per calcolo misura vetro anta MINI IKS
 Mini Iks door Technical Data to calculate glass dimension

